

DIST.	COUNTY	ROUTE	POST MILES TOTAL PROJECT	SHEET NO.	TOTAL SHEETS
2	LASSEN	N/A	N/A	1	2

LARRY MILLAR
REGISTERED ENGINEER - CIVIL
Larry D. Millar
9/3/10
PLANS APPROVAL DATE

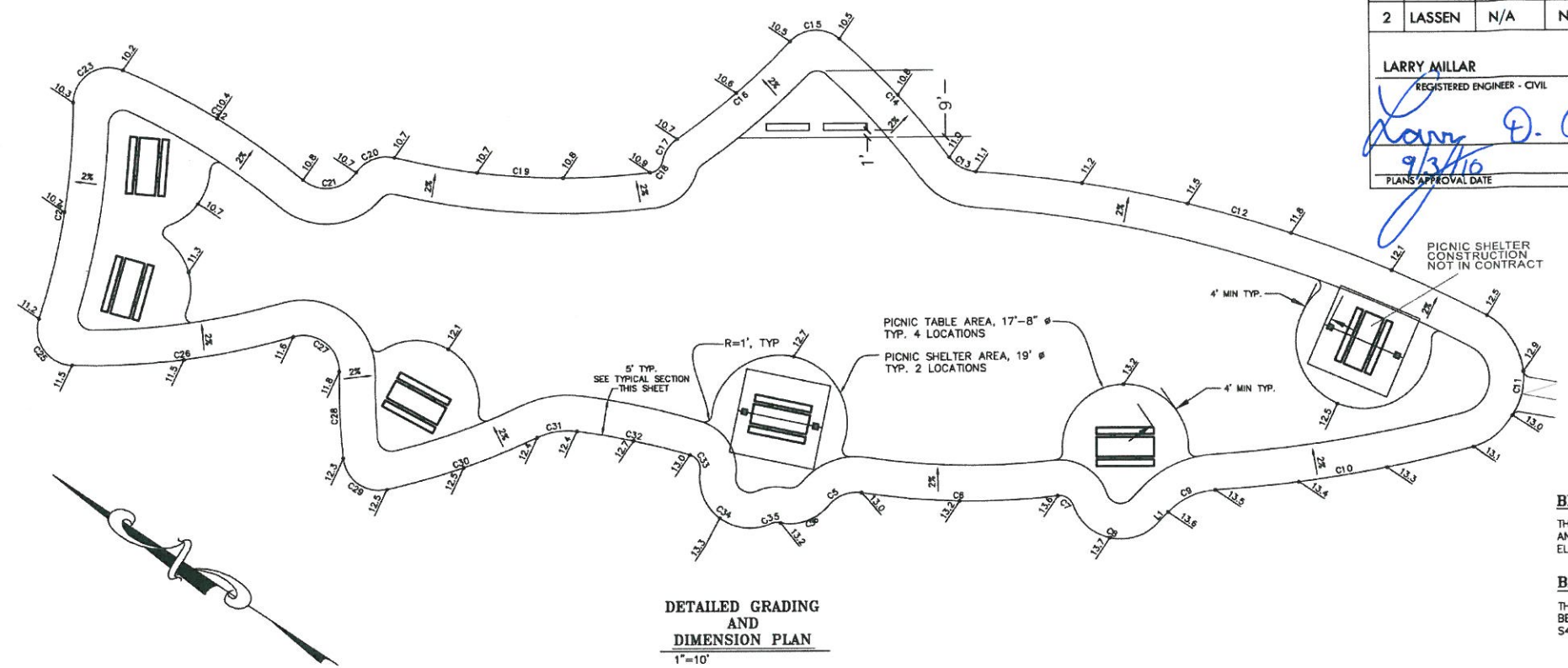
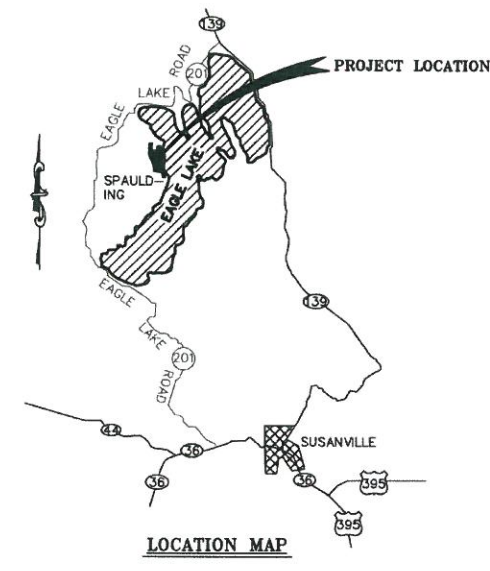

BENCHMARK:
THE BENCHMARK FOR THIS PROJECT IS AN IRON PIPE LABELED "BM #19" ELEV. = 5112.20

BASIS OF BEARINGS:
THE BASIS OF BEARINGS IS THE LINE BETWEEN CP#102 & CP#103 BEING S47°45'23" W 349.55'.

CONTROL POINTS:

#102	5/8" REBAR MARKED LS 4530	N: 2128333.8490	E: 6901102.7280	ELEV: 5112.71
#103	1/2" IP MARKED LS 3202	N: 2128098.7830	E: 6900843.8830	ELEV: 5128.32
#104	5/8" REBAR MARKED LS 4530	N: 2128718.2770	E: 6900824.4460	ELEV: 5110.90

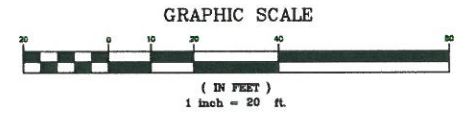
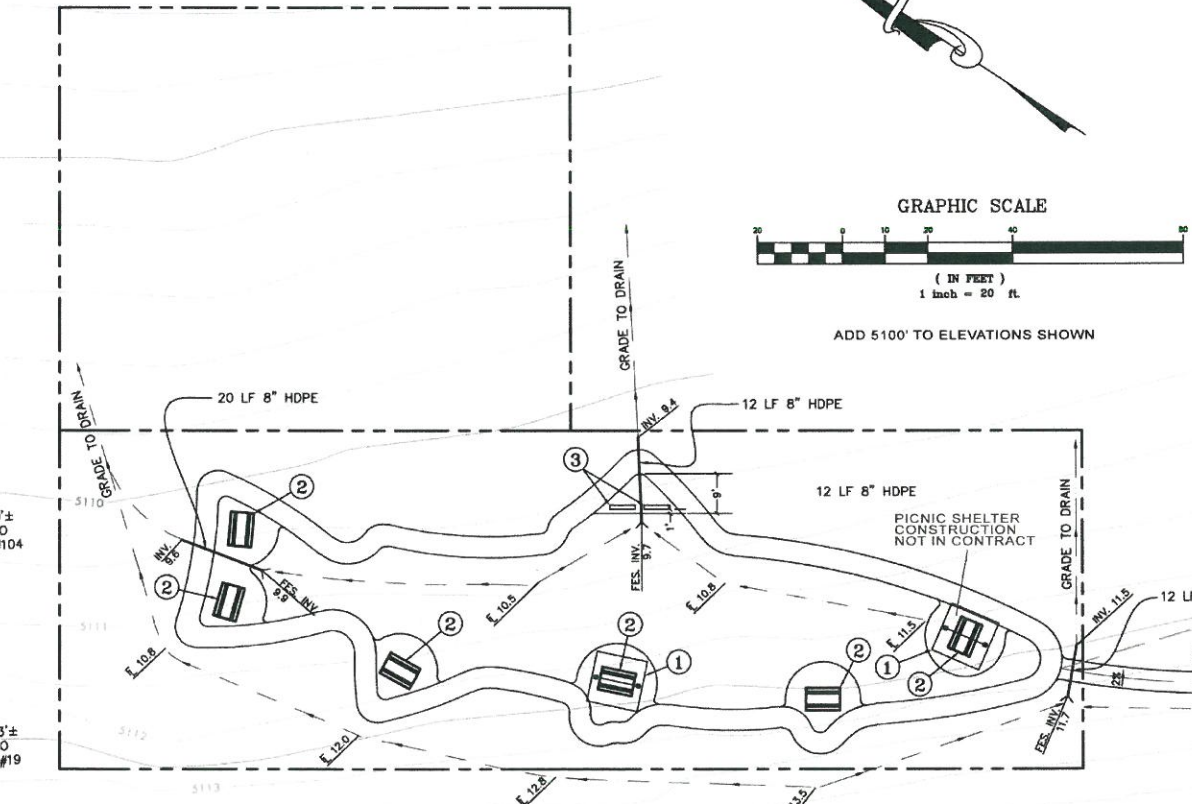

LINE TABLE

LINE	LENGTH	BEARING
L1	2.16'	S80°28'20"E

CURVE TABLE

CURVE	LENGTH	RADIUS	DELTA
C1	67.87'	200'	192°40'
C2	40.63'	100'	231°38'
C3	110.19'	100'	83°07'53"
C4	48.93'	100'	28°53'20"
C5	7.35'	5'	141°14"
C6	27.82'	100'	154°03'32"
C7	2.73'	2'	78°59'52"
C8	14.41'	7'	117°59'32"
C9	7.50'	10'	42°59'27"
C10	38.73'	180'	114°31"
C11	23.89'	10'	136°53'09"
C12	74.85'	180'	23°49'29"
C13	4.37'	5'	50°03'52"
C14	22.86'	100'	130°54'
C15	7.88'	5'	88°50'57"
C16	20.99'	100'	120°1'38"
C17	3.85'	5'	44°03'52"
C18	2.52'	2'	72°09'19"
C19	36.21'	100'	20°44'41"
C20	8.12'	5'	70°02'11"
C21	8.44'	5'	86°40'40"
C22	28.68'	100'	170°02'28"
C23	9.85'	5'	112°32'59"
C24	30.95'	100'	17°44'02"
C25	9.28'	5'	106°19'46"
C26	31.33'	100'	172°21'27"
C27	9.38'	5'	107°27'35"
C28	12.28'	100'	79°1'22"
C29	8.44'	5'	86°40'01"
C30	22.37'	100'	12°49'02"
C31	5.72'	10'	32°50'32"
C32	16.20'	100'	81°15'59"
C33	2.87'	2'	82°53'33"
C34	15.06'	7'	123°17'15"
C35	1.27'	2'	60°50'35"
C36	3.15'	2'	36°14'30"

- NOTE:**
- SCORE CONCRETE 1-1/2" DEPTH, 1/4" WIDTH WITH 1/4" RADIUS EDGE 10' O.C. MAX
 - INSTALL EXPANSION JOINTS MAX 20' O.C. WITH 1/2" X 4" EXPANSION FELT 1/2" WIDE X 1/2" DEEP RESILIENT POLYURETHANE SEALANT MATCH CONCRETE COLOR.
 - USE DAVIS COLORS TERRA COTTA FOR THE PATH AND PALOMINO FOR THE TABLE AND BENCH PADS
 - PATH AND PADS TO BE STAMPED WITH TROUT GRAPHIC SHOWN TO THE LEFT. STAMP APPROXIMATELY 12" TO 36" O.C. OWNER TO PROVIDE STAMPS.

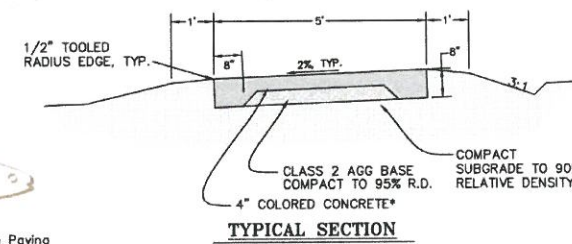

- CALLOUT NOTES:**
- 1 Picnic Shelter per Detail Sheet 2.
 - 2 Concrete Picnic Table by Outdoor Creations (530)337-6774 Model 100S Color Outback
 - 3 Concrete Bench by Outdoor Creations (530)337-6774 Model 402 Color Outback

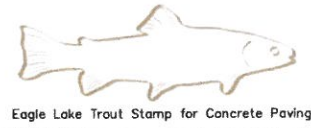

STANDARD DRAWING

FILE NO.	DESIGN BY:	CHECKED:	APPROVAL RECOMMENDED BY:
DESIGN DATE 08/26/2010	DETAILS BY:	CHECKED:	DESIGN SUPERVISOR
SUBMITTED BY:			

PREPARED BY
THE COUNTY OF LASSEN PUBLIC WORKS & TRANSPORTATION DEPARTMENT
707 NEVADA ST. SUITE #4 SUSANVILLE, CA 96130 PHONE (530) 251-8288 FAX (530) 251-2675

BRIDGE NO.	N/A	SPAUDING PICNIC AREA SITE PLAN
POST MILE	N/A	
DISREGARD PRINTS BEARING EARLIER REVISION DATES		
REVISION DATES (PRELIMINARY STAGE ONLY)		SHEET 1 OF 2

